

PVC Coated Liquidtight Connectors - Straight w/ Ground

Calbond PVC coated liquidtight connectors are used with Liquidtight Conduit. The sleeve on the liquidtight connector is sized specifically to tighten around PVC conduit. Pulling compound is recommended for ease of installation. Fittings are provided with a flexible sleeve on the conduit side and a sealing form on both the box side and the mating part of the gland.



Features:

- Exterior PVC coating thickness is a minimum 0.040"
- Sizes available are 1/2" to 4"
- The length of the sleeve extension(s) shall be at least equivalent to the nominal conduit size for sizes 1/2"- 2". For sizes 2-1/2"- 6", the length of the sleeve extension(s) shall be at least 2".
- Available in straight, 45 degree or 90 degree body configurations

Standards:

- CSA Standard: C22.2 No. 18

UL listings include:

- Ferrous electrical conduit: File # DYIX.E226472
- Ferrous electrical conduit with PVC coating: File # DYJC.E226472

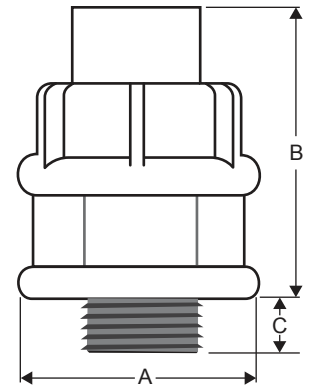

Straight w/ Ground							
Item Number	Trade Size	A	B	C	Weight Per 100 (lbs)	Ground Wire	Aluminum Item Number
PV0300LT38G	3/8"	1.24	1.88	0.56	20	14-8	
PV0500LT50G	1/2"	1.46	2.06	0.56	20	14-8	PV0500LT50GSA
PV0700LT75G	3/4"	1.74	2.38	0.56	30	14-4	PV0700LT75GSA
PV1000LT100G	1"	1.96	3.06	0.75	40	14-4	PV1000LT100GSA
PV1200LT125G	1-1/4"	2.33	3.75	0.81	80	14-4	PV1200LT125GSA
PV1500LT150G	1-1/2"	3.33	4.19	0.81	90	14-4	PV1500LT150GSA
PV2000LT200G	2"	3.89	5.06	0.88	170	14-4	PV2000LT200GSA
PV2500LT250G	2-1/2"	4.52	6.13	1.00	300	1/0-8	PV2500LT250GSA
PV3000LT300G	3"	5.27	6.25	1.00	420	1/0-8	PV3000LT300GSA
PV4000LT400G	4"	6.21	6.50	1.13	620	3/0-6	PV4000LT400GSA